

GOLDI_66GN1 - PERC Monocrystalline Module

Key Features

- Higher module conversion efficiency (up to 19.64%) benefit from Passivated Emitter Rear Contact (PERC) technology
- Up to +3% positive power output guaranteed.
- Reducing equipment loss increases the power generation in overall system.
- Loss minimization due to excellent temperature co-efficient.
- Excellent low light and longer wavelength response.
- BOS cost reduction for 1500 VDC system by connecting more modules in a string.
- Better performance even at low irradiance condition.
- Higher specific yield.

Quality & Reliability

- Manufactured in an ISO 9001:2015, ISO 14001:2015, OHSAS 18001:2007 certified facility.
- Manufactured using high grade raw materials from reputed international suppliers adopting a stringent quality criteria.
- PID resistant (IEC 62804).
- IP67/IP68 rated junction box for long-term weather endurance.
- 25 years output warranty.
- Certified for hail resistance.

Technical Data for GOLDI_66GN1 - PERC Monocrystalline Module

Electrical Parameter at STC

Module Type	GOLDI066FPRC24			
Capacity rating - Pmax(Wp)	330	335	340	345
Power Tolerance (%)	0 - 3	0 - 3	0 - 3	0 - 3
Module efficiency (%)	18.52	18.80	19.08	19.36
Rated voltage - Vmp(V)	35.90	36.10	36.35	36.65
Rated current - Imp(A)	9.20	9.28	9.36	9.42
Open circuit voltage - Voc(V)	44.40	44.70	44.95	45.10
Short circuit current - Isc(A)	9.57	9.64	9.73	9.81

Under Standard Test Conditions (STC) of irradiance of 1000 W/m², spectrum AM 1.5 and cell temperature of 25°C.

Electrical Parameter at NOCT

Capacity rating - Pmax(Wp)	245.30	248.81	252.67	256.42
Rated voltage - Vmp(V)	33.30	33.49	33.72	34.00
Rated current - Imp(A)	7.37	7.43	7.49	7.54
Open circuit voltage - Voc(V)	41.38	41.66	41.89	42.03
Short circuit current - Isc(A)	7.75	7.81	7.88	7.94

NOCT irradiance of 800 W/m², ambient temperature of 20°C, Wind speed 1m/sec

Guarantees and certifications

Product warranty**	10 years
Performance guarantee**	Limited warranty for power output :- 90% for 10 years, and 80% for 25 years
Product Certified	IEC 61215, IEC 61730, CE, BIS (In Progress)

Mechanical specification

Solar cells	66 pcs PERC Monocrystalline Silicon
Encapsulation	Ultra - clear PID free EVA (Ethylene-Vinyl-Acetate)
Backside	UV protected reflective backsheets
Frame	Silver Anodized Aluminium Alloy (screwless)
Front glass	3.2 mm, High Transmission, AR Coated Tempered Glass
Dimensions	(L)1800 mm x (W)990 mm x (H)35 mm
Weight	20.2kg
J-box	IP67/IP68 certified 4-rail, 3 diodes junction box
Cable	Solar cable 400mm to 1200 mm length, 4 mm ²
Connectors	MC4 compatible connectors
Application Class	Class A
Electrical Safety	Class II
Fire Safety	Class C (Type 1)
Surface load	(snow load 5400 Pa, wind load 2400 Pa).

Temperature Coefficients (TC)

Temperature Coefficient (Voc)	-0.29% /°C
Temperature Coefficient (Isc)	0.05% /°C
Temperature Coefficient (Pmax)	-0.38% /°C

Permissible Operating Conditions

Temperature range	-40°C to + 85°C
Maximum system voltage	1500/1000 VDC
NOCT	45 ± 2°C
Hail resistance	Maximum diameter of 25 mm with velocity 23 m/s

IV Curves

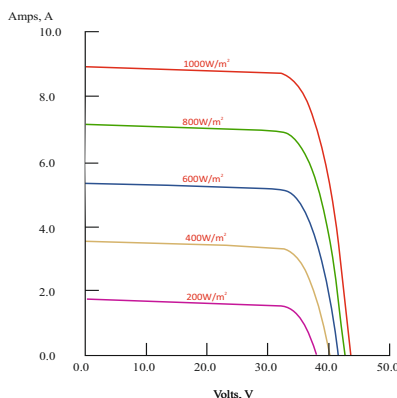

Drawing measurement in mm

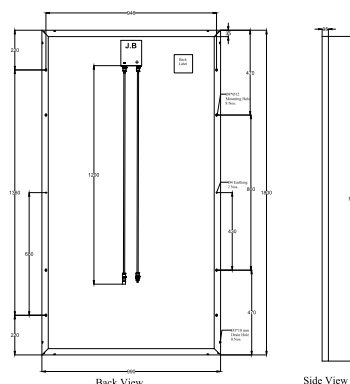

Container	20' GP	40' HC
Pallets/ container	12	28
Modules / Container	360	840

- For handling & installation instructions refer Goldi Solar Installation Manual
- Dispose-off the product as E-Waste after end of its working life.
- ** Refer to Goldi Solar's warranty document for terms and conditions.
- Due to constant product modifications, Goldi Solar reserves the right to amend the above specifications without prior notice.